

## XLa Quick Start guide

After setting up your system using the following instructions, please read the Installation and User Guide that came with your amplifier. In particular, pay attention to warnings about ventilation and volume level settings. It is important to leave 5" of free air space above the amplifier and 3" on each side for proper ventilation. Also, please note the chapter titled "Listening at Higher Volumes" on page 7. CasaTunes is not responsible for damage to speakers caused by improper operation of your amplifier.

### ***Wiring***

Route the cables from your audio source to the input jacks in the rear of the amplifier in the following manner.

#### **XLi**

Using the special cables supplied with your XLi, plug the small "3.5mm" connector end of the first cable into Z1 of the XLi card. At the other end of the first cable plug the white RCA connector into the jack at channel 1 on the back of the XLa. Plug the red RCA connector into the jack at channel 2. Channel 1 will then be the Left output and channel 2 will be the Right output. Plug the second cable into Z2 and plug its white RCA connector into channel 3 and its red into channel 4. Continue in the same manner with cables from Z3, Z4, Z5, and Z6 going to channels 5 & 6, 7 & 8, 9 & 10, and 11 & 12 respectively.

#### **XLe**

Using standard RCA to RCA connectors, plug the connectors at one end into the XLe chassis Zone Audio Output 1, so that Red is plugged into the bottom, R, connector (think of it as Red is Right, both start with R) and the other plug (usually white or black) is plugged into the top, L, connector. At the other end plug the white or black connector into channel 1 and the red connector into channel 2. Similarly plug a cable from Zone Audio Output 2 on the XLe to channels 3 & 4 of the XLa. Continue until you have Zone Audio Output 6 plugged into channels 11 & 12. If you have more than 6 rooms and are using a second XLa, plug a cable from Zone Audio Output 7 into channels 1 & 2 of the second XLa. Continue in the same manner.

To turn the amplifier on and off by control of CasaTunes, plug a mono (stereo will work, too) 3.5mm to 3.5mm cable from "Triggers 1-6" to the Trigger input on the left end of the rear of the XLa and slide the TURN ON MODE switch to the right as shown in the following figure 5:

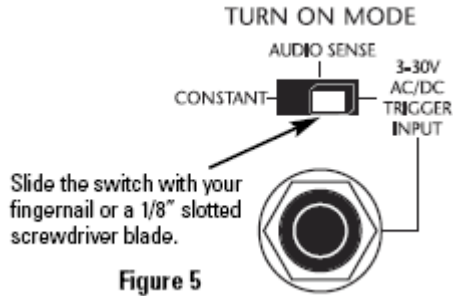

Figure 5

Plug another 3.5mm to 3.5mm cable from “Triggers 7-12” to the second XLa, if equipped.

## XLi and XLe

Wire your speaker wires to the outputs of the channels so that the audio from zone 1 will go to the speakers wired to channel 1 (left speaker) and channel 2 (right speaker), the audio from zone 2 will go to speakers wired to 3 and 4, etc. Pay attention to the “polarity” of the speakers, so that the wire going to the + side of a speaker goes to the top, +, connector and the wire going to the - side of the speaker goes to the bottom, -, connector of the XLa.

## Switch settings



Check to be sure that all the level controls are set so that the line is facing straight up (12:00 o’clock position). Check to make sure that the switches below the level controls

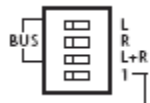

are set so that L, R, and L+R are to the left (OFF) and the switch labeled 1 (the bottom most of the four switches) is to the right (ON). The level control and the switches should have been set at the factory, but it is a good idea to double-check the settings.

## XLi

Verify that the TURN ON MODE switch is set to the center position. This allows the amplifier to sense when audio is coming out of the XLi and turn itself on. The XLa will turn itself back off when music is not playing for about 3 minutes. If you have very sensitive speakers and listen to quiet music, the volume level you listen at may not trigger the Audio Sense input of the XLa. If you have this problem, slide the TURN ON MODE switch to the left, CONSTANT, position. The amplifier will always be on when the switch is in this position.

## XLe

If you have wired a cable from the XLe trigger output to the XLa, make sure the TURN ON MODE switch has been moved to the right, 3-30V AC/DC TRIGGER INPUT position.