

CasaTunes Setup (Cont)

For any distribution system source input that CasaTunes supplies a music stream, pick CasaTunes Media Player as the Source type and configure the first stream as shown:

Select audio device:

Select speakers:

Configure the second stream (CT-2 only) as shown.

Select audio device:

Select speakers:

For other source inputs, select a source type from the pull down menu or choose "Unsupported Source".

Select Controller	Music Services	Update CasaTunes License
Sources	Music Searches	Change Time Zone
Rooms		

Music Services	SqueezeBox Settings
<input type="checkbox"/> Grooveshark <input checked="" type="checkbox"/> iPod Classic (No WiFi) <input checked="" type="checkbox"/> iTunes Music <input type="checkbox"/> iNetCustom <input checked="" type="checkbox"/> SHOUTcast <input type="checkbox"/> Spotify <input checked="" type="checkbox"/> SqueezeBox (Includes	<p>Setup an account on http://www.MySqueezeBox.com, then select and music apps such as Pandora, SiriusXM, and Slacker for use with Casa SqueezeBox Setup Video and Help for instructions.</p> <p>Note: You must restart the SqueezeBox server below each time you re your music apps.</p> <p>See which SqueezeBox Apps are supported by CasaTunes.</p> <p>▼ SqueezeBox Account Information</p> <p>Username: <input type="text" value="kimnann@casatunes.com"/></p>

Enable all of the music services you are interested in.

Some music services require setting up SqueezeBox. Follow the directions in CasaSetup.

Some music services require paid accounts, as noted in CasaSetup.

Now, name all of your sources and rooms and set your Time Zone and Update settings. Check the Hide check box for any Sources or Rooms not used. Click on Advanced Settings and use the Project Information page to create a backup of the project.

Control

Use our control apps.



OR

Go to <http://CasaServer/CasaTunes> on any PC, or <http://CasaServer.local/CasaTunes> on any Mac connected to the network

Need Help?

Check out the videos at <http://www.YouTube.com/CasaTunes>

Check out our Tech Notes at <http://www.CasaTunes.com/guides>

For live help, email us at support@CasaTunes.com or phone us at 888-855-2272

CasaTunes®

Quick Start Guide for 6 Room Music System



Follow these steps to install your CasaTunes music system for up to 6 rooms.

SEE IMPORTANT NOTE ON NEXT PAGE!

Included Items

Power Adapter Qty 1



Serial Cable Qty 1



Network Cable Qty 1



Audio Cables Qty 2



Power Cable Qty 1



Keypad Controls and Keypad Hub Connection Plate

Connect the Components

NOTE: Make sure the controller switch on the back of the amplifier is set correctly:

Master = Zones 1-6

Slave 1 = Zones 7-12

Slave 2 = Zones 13-18

NOTE: Do not plug a live internet cable into the Keypad Jack!

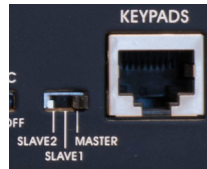

Audio outputs:
First (CT-1&2)

Audio outputs:
Second (CT-2 only)

From
external devices
(tuners, cable
boxes, etc.)

Use Audio Cables to
connect stream outputs
to 6X6 system's
RCA inputs

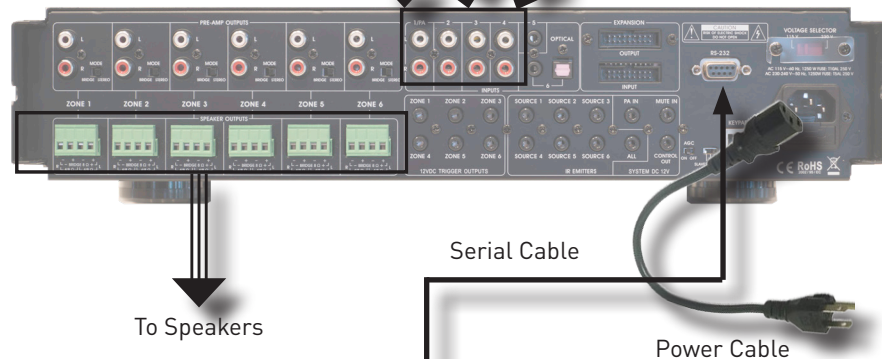

To Speakers

Serial Cable

Power Cable

Connect to LAN and Power

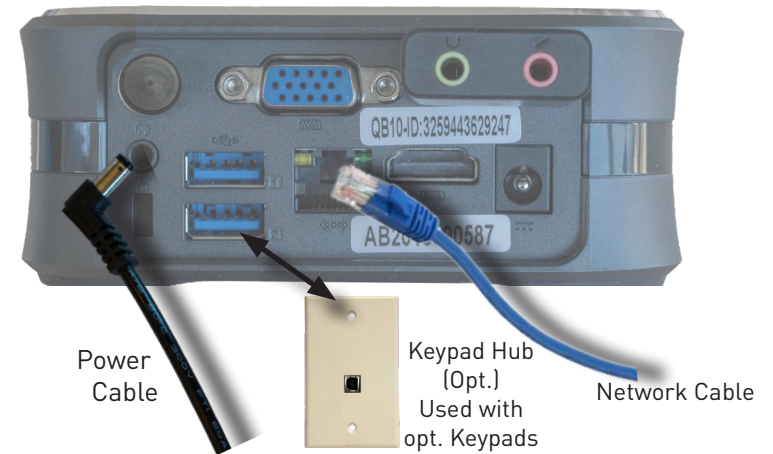

Power
Cable

Keypad Hub
(Opt.)
Used with
opt. Keypads

Network Cable

CasaTunes Setup

Turn on the system at this time.

Open any browser on the
LAN and go to CasaSetup:

PC: <http://CasaServer/CasaSetup>
Mac: <http://CasaServer.local/CasaSetup>

Use CasaSetup to select the type of Audio Distribution system. Select the COM port you will be using. Usually, the default COM port will be the correct choice.

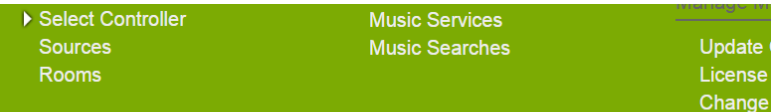

Controller Settings

Select Controller Type: CasaTunes CT-6X6 MultiZone Controller A ▾

Number of Units: 1 ▾

☐ Are you using a CasaTunes CT-3, CT-3S or CTMS-3 music server or streamer?

Serial Port Settings

Serial Port: COM Port 11 ▾

After clicking on Save, the Sources and Rooms refer to the source inputs and zone or room outputs of the Distribution system you are controlling. (continued on back page).

Important! Stop the service, wait and then Start the service